

# SHED 10

AUCKLAND  
CONVENTIONS  
venues & events



## A BLANK CANVAS TO MAKE YOUR OWN

Shed 10 is a 100-year-old cargo shed full of character and historical significance. Built in 1910, Shed 10 is the only remaining original building on Auckland's Queens Wharf. This heritage-listed building has undergone a thoughtful restoration, providing facilities for glamorous gala dinners and cocktail functions.

### FEATURES

- Located on Queens Wharf on the Auckland waterfront
- Uninterrupted views of the Waitematā Harbour
- 4,400m<sup>2</sup> over two levels
- Multipurpose event venue
- Walking distance from public transport hubs and retail precincts
- Close to multiple hotels and entertainment options

Discover **Shed 10** here.

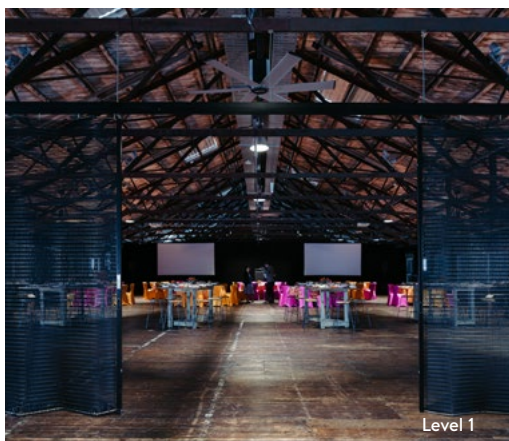
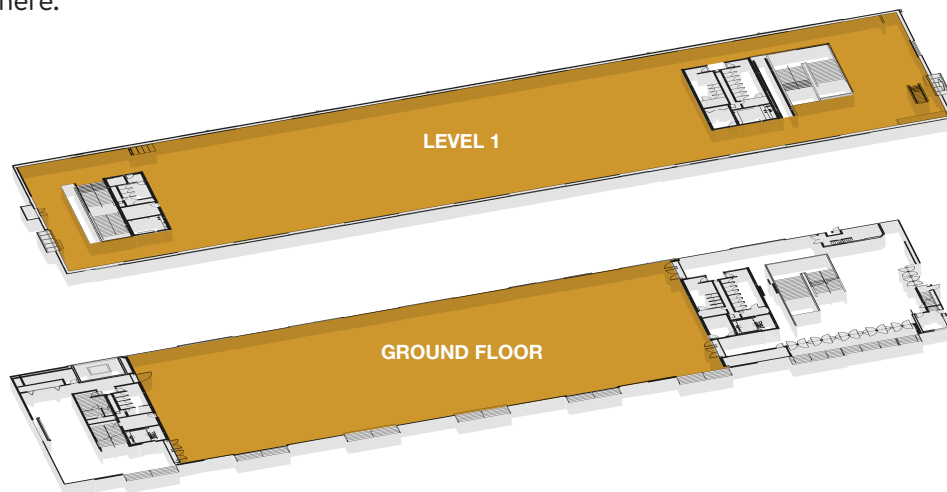

### Capacity Chart

ROOMS	HEIGHT m	AREA m <sup>2</sup>	THEATRE	CABARET	BANQUET	COCKTAIL	EXHIBITION
Ground Floor	4.9m	2216m <sup>2</sup>	1575	580	700	2000	61 booths
Level 1	3.75m	2204m <sup>2</sup>	1000	640	750	1000	53 booths

Please note: All capacities are guidelines only and are based on the maximum use of the space available for standard setups. They may be reduced by staging, technical equipment, dance floors, type of menu being served or entertainment.