



# PARKSIDE

HOTEL AND APARTMENTS



# PARKSIDE

HOTEL AND APARTMENTS





AUCKLAND

# PARKSIDE

HOTEL AND APARTMENTS

An apartment style hotel with excellent meeting room and guest room facilities, the Parkside Hotel & Apartments offers a warm welcome in Tāmaki Makaurau – Auckland city. Our central CBD location set amongst the backdrop of tranquil park surroundings is unmatched.

Featuring easy access to motorways, undercover secure parking and a short walk to the major shopping and vibrant entertainment areas, you can be confident your next function will be a success.

# CONFERENCING & MEETING FACILITIES

Parkside Hotel & Apartments has 3 purpose-built function rooms perfectly suited for workshops, training seminars, board meetings, product launches or cocktail functions. All 3 rooms are located on the mezzanine level.



## ABEL TASMAN

This space is suited to smaller meetings such as board meetings, one on one meetings.

Capacity is up to 12 delegates in a Boardroom set up.



## TONGARIRO

This space is light and airy with views onto Greys Avenue. It is 45 sqm and suited to various meeting set ups and event types.

Capacity is between 15- 30 for cocktail, banquet, theatre style or classroom set ups.



## RAKIURA

The Rakiura room is the largest single space at 102 sqm with plenty of light and views over the park and the street.

Capacity is between 25 – 70 depending on the meeting or event type. Perfect for a smaller evening event.



## KAHURANGI

This is exclusive use of all three rooms including the mezzanine balcony and meeting rooms lobby area; dividing doors may be opened to provide full use of the space or choose to keep the spaces separate.

Capacity when the spaces are opened is up to 100 for cocktail or banquet.

We have a projector, screen, speakers and microphone available for hire.

**Note:** the Tongariro & Rakiura rooms can also be opened into one larger space for medium size events.



## FLOOR PLAN

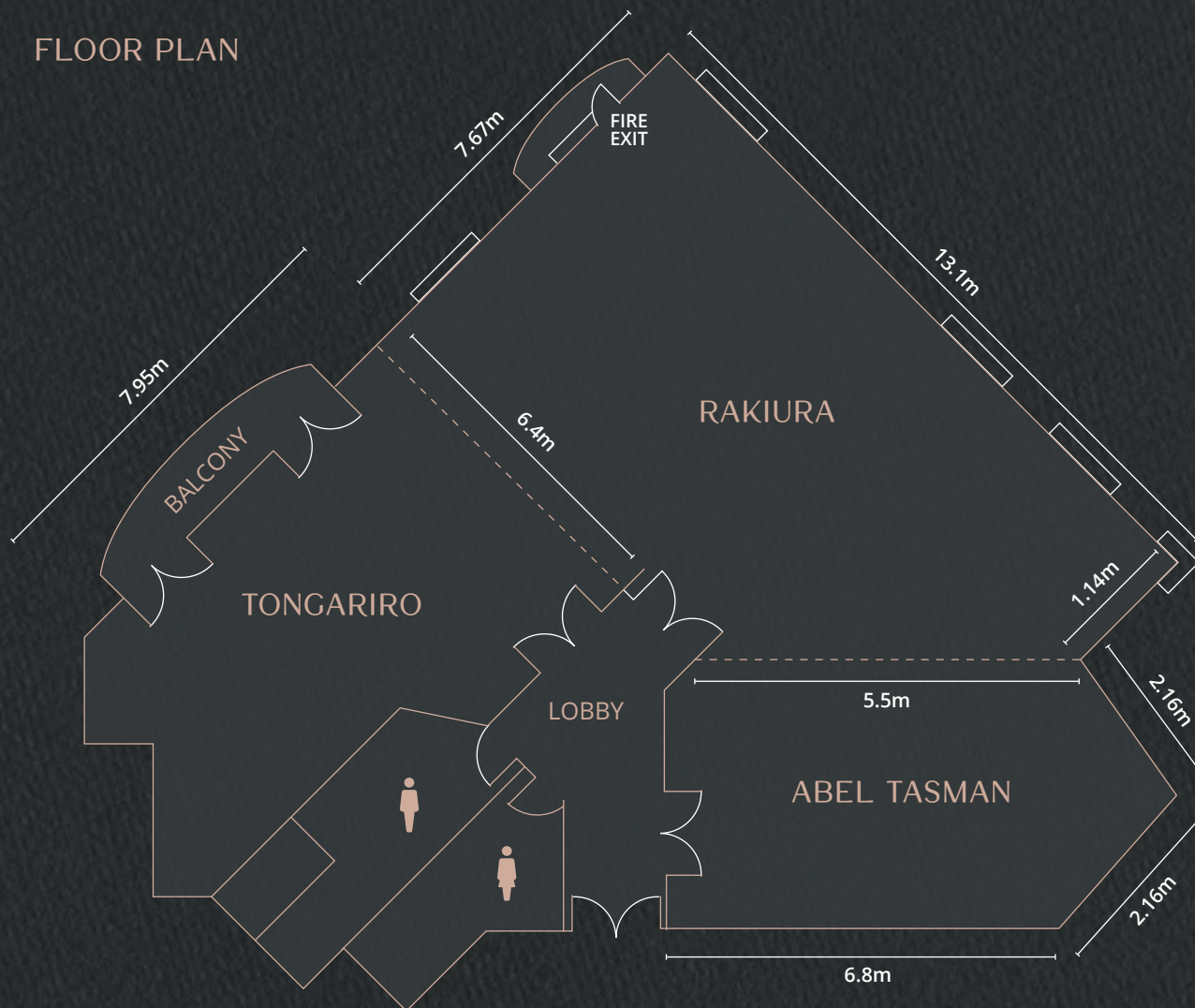

## CAPACITY CHART

	TONGARIRO	RAKIURA	ABEL TASMAN	KAHURANGI (rooms combined)
AREA (m <sup>2</sup> )	45	102	40	187
HEIGHT (m <sup>2</sup> )	2.4	2.4	2.4	2.4
THEATRE	30	70	-	150
CLASS ROOM	24	40	-	60
U-SHAPE	15	25	-	-
BOARDROOM	18	32	10	-
COCKTAIL	30	70	-	100
BANQUET	30	50	10	80
CABARET	18	36	-	65



# CATERING OPTIONS

Talk to us about your catering requirements, we can organize a wide variety of refreshments and meals depending on your time limits, budget and dietary requirements.

## STANDARD DAILY DELEGATE PACKAGE

\$60pp

### Arrival Tea & Coffee

#### Morning Tea

- Tea & Coffee
- 2x Sweet or Savoury Options

#### Lunch

- 1x Sandwich, Wrap or Panini
- 1x Salad
- 1x Sweet or Savoury Option

#### Afternoon Tea

- Tea & Coffee
- 2x Sweet or Savoury Options

## PREMIUM DAILY DELEGATE PACKAGE – GOURMET FOOD SELECTION

\$65pp – minimum 15 pax

### Arrival Tea & Coffee

#### Morning Tea

- Tea & Coffee
- 2x Sweet or Savoury Options

#### Lunch

- 1x Sandwich, Wrap or Sushi
- 1x Salad
- 1x Sweet Option

#### Afternoon Tea

- Tea & Coffee
- 2x Sweet or Savoury Options

Please note that pricing is subject to change. An accurate cost will be provided at the time of quotation.

**Barista Coffee Available** Charged on consumption

**Canapes and Dinner** Price on application



# GUEST ROOMS

The Parkside Hotel & Apartments has 40 guest rooms ranging from Deluxe King Rooms to Executive Penthouse Suites. Classically styled, each room has its own kitchenette, laundry and private balcony with many featuring spectacular views over the lush Myers Park or the city and beyond. From the extensive in-room amenities to in-room spa options and FREE WiFi we've made it easy to find the room that's perfect for you. We offer competitive accommodation rates for multi-day or pre/post conference packages.



## ROOM FACILITIES

- Desk space
- Spa bath (Limited room types)
- Private balconies, all room types
- Tea and coffee making facilities
- Sky TV
- Complimentary Wifi
- Hair dryer
- Iron and ironing board
- Washer / Dryer
- Kitchenette
- Air conditioning



## HOTEL FACILITIES

- Parking facilities (available on request at additional cost)
- Continental breakfast available upon request (\$18.50pp)
- Pool and Spa
- Gym
- Business centre
- Lobby lounge







# LEISURE FACILITIES

At the Parkside Hotel & Apartments your comfort and convenience are our utmost priority. Whether it's a post conference work out in our in house gym or an early morning swim to start the day in our pool, we are dedicated to helping you make the most of your time with us.



# LOCAL & NEARBY ATTRACTIONS

For business and pleasure. Our unique location on a tree lined street in the heart of Auckland means world standard shopping and entertainment are at our back door. We're a short stroll to the culture centre of Auckland including the Civic Theatre, Auckland Art Gallery and Aotea Square.

Karanghape Road is a few minutes walk away with its bohemian cafés bars and stores.



- Commercial Bay shopping
- Domain Wintergardens
- Myers Park (on our doorstep)
- Albert Park
- Sky Tower
- Kelly Tarlton's Sealife Aquarium
- Viaduct Harbour
- The Civic Theatre
- Eden Park
- Mt Smart Stadium
- Spark Arena

# CORPORATE WELLNESS WITH THE SPA NOMAD

Parkside have teamed up with The Spa Nomad NZ to offer companies the opportunity to prioritise employee wellness as a part of their corporate benefits or conferencing program.

With employee burnout and fatigue on the rise, health and wellness are increasingly becoming a focus. Business leaders understand the importance of employee wellbeing and are exploring what they can do to assist in alleviating workplace stress and improving employee engagement.

Simple massage and facials can play an important and welcome role in giving individuals a boost in mood, helping to de-stress, relax and improve morale.

The Spa Nomad provide an easy and accessible solution to give your delegates access to massage and wellness services on site with our team bringing all the equipment and tools needed.

Ask us about our corporate wellness treatment options including:

## BACK, NECK & SHOULDER MASSAGE

15 minutes or 30 minutes options

## HOLISTIC FACIAL

30 minutes

**Visit:** [thespanomad.nz/corporate-packages](https://thespanomad.nz/corporate-packages) for more information



# THE SPA NOMAD



E: [info@parksidehotel.co.nz](mailto:info@parksidehotel.co.nz)

T: 09 302 2522

A: 100 Greys Avenue, Auckland

[PARKSIDEHOTEL.CO.NZ](http://PARKSIDEHOTEL.CO.NZ)